

CONTRACT: DA00451 WBS ELEMENT: 15401.1048011

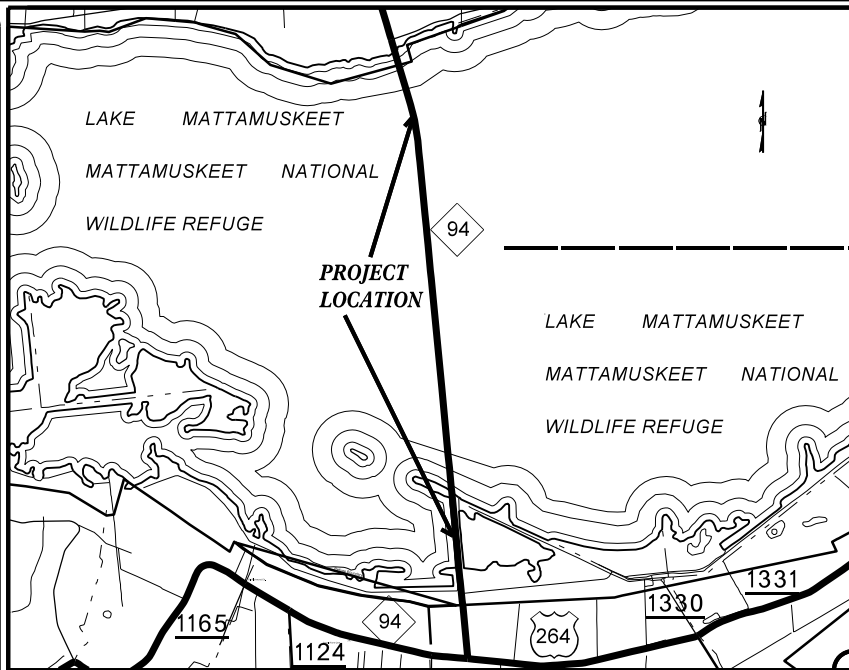

VICINITY MAP

STATE OF NORTH CAROLINA  
DIVISION OF HIGHWAYS

**HYDE COUNTY**

LOCATION: ALONG NC 94 OVER LAKE MATTAMUSKEET

TYPE OF WORK: SHORELINE STABILIZATION  
DAMAGE FROM HURRICANE FLORENCE



STATE	STATE PROJECT REFERENCE NO.	SHEET NO.	TOTAL SHEETS
N.C.	15401.1048011	1	
STATE PROJ. NO.	F.A. PROJ. NO.	DESCRIPTION	

LAKE MATTAMUSKEET  
NATIONAL WILDLIFE REFUGE



LAKE MATTAMUSKEET  
NATIONAL WILDLIFE REFUGE

PROJECT LENGTH

TOTAL PROJECT LENGTH = 1.56 MILES

Prepared In the Office of:  
**DIVISION OF HIGHWAYS**  
113 Airport Drive, Suite 100, Edenton NC, 27932

2018 STANDARD SPECIFICATIONS

LETTING DATE:

W. B. HOBBS, PE  
DIVISION PROJECT ENGINEER

CHRIS SLACHTA  
DIVISION PROPOSALS ENGINEER

D.H. STALLINGS  
DIVISION STAFF ENGINEER

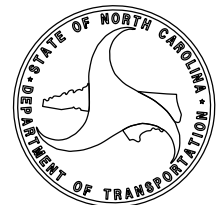

Shoreline Stabilization on NC 94  
 Lake Mattamuskeet Causeway  
 Hyde County Quad Name New Holland

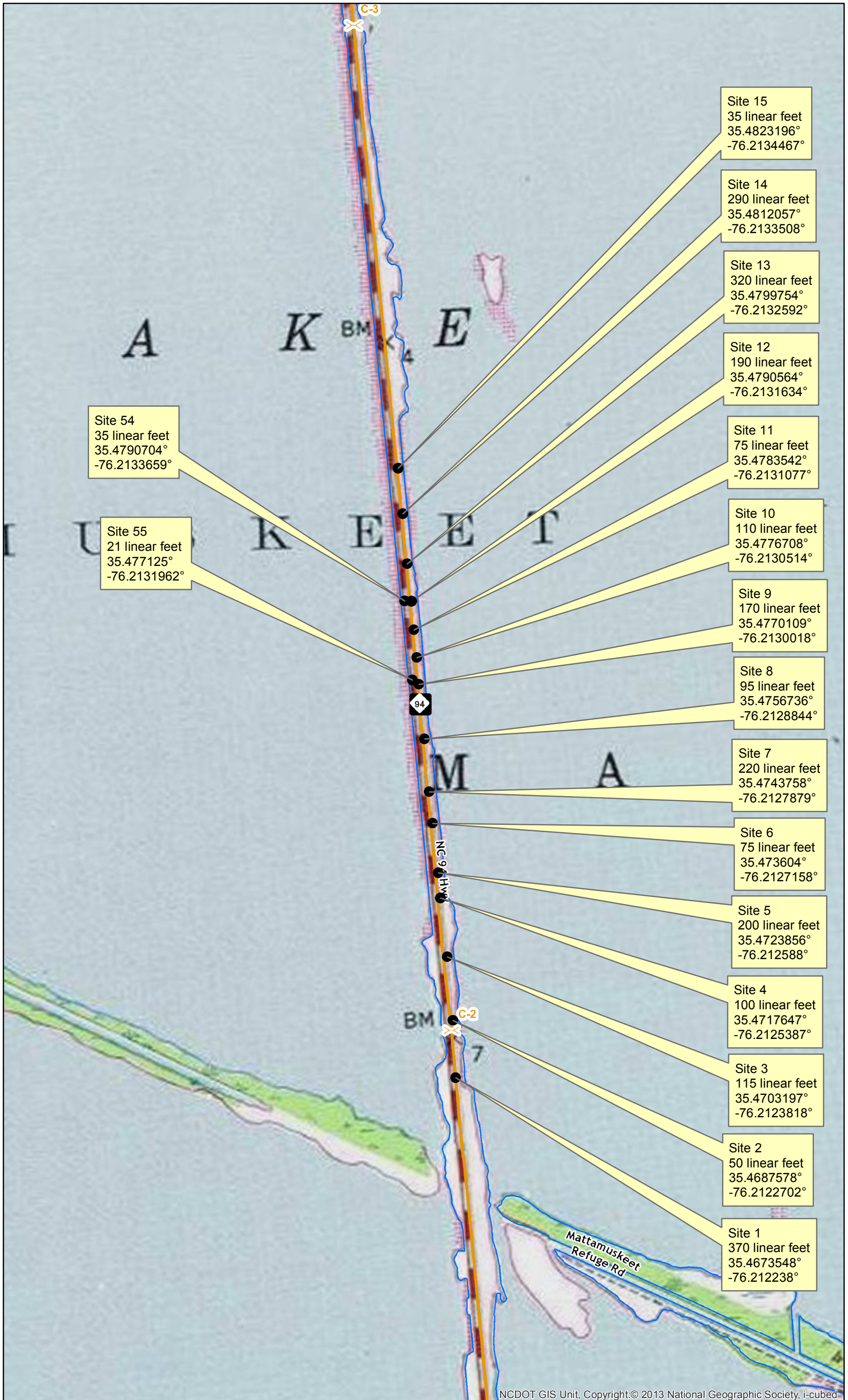

NCDOT GIS Unit, Copyright:© 2013 National Geographic Society, i-cubed



# Shoreline Stabilization on NC 94 Lake Mattamuskeet Causeway Hyde County Quad Name New Holland

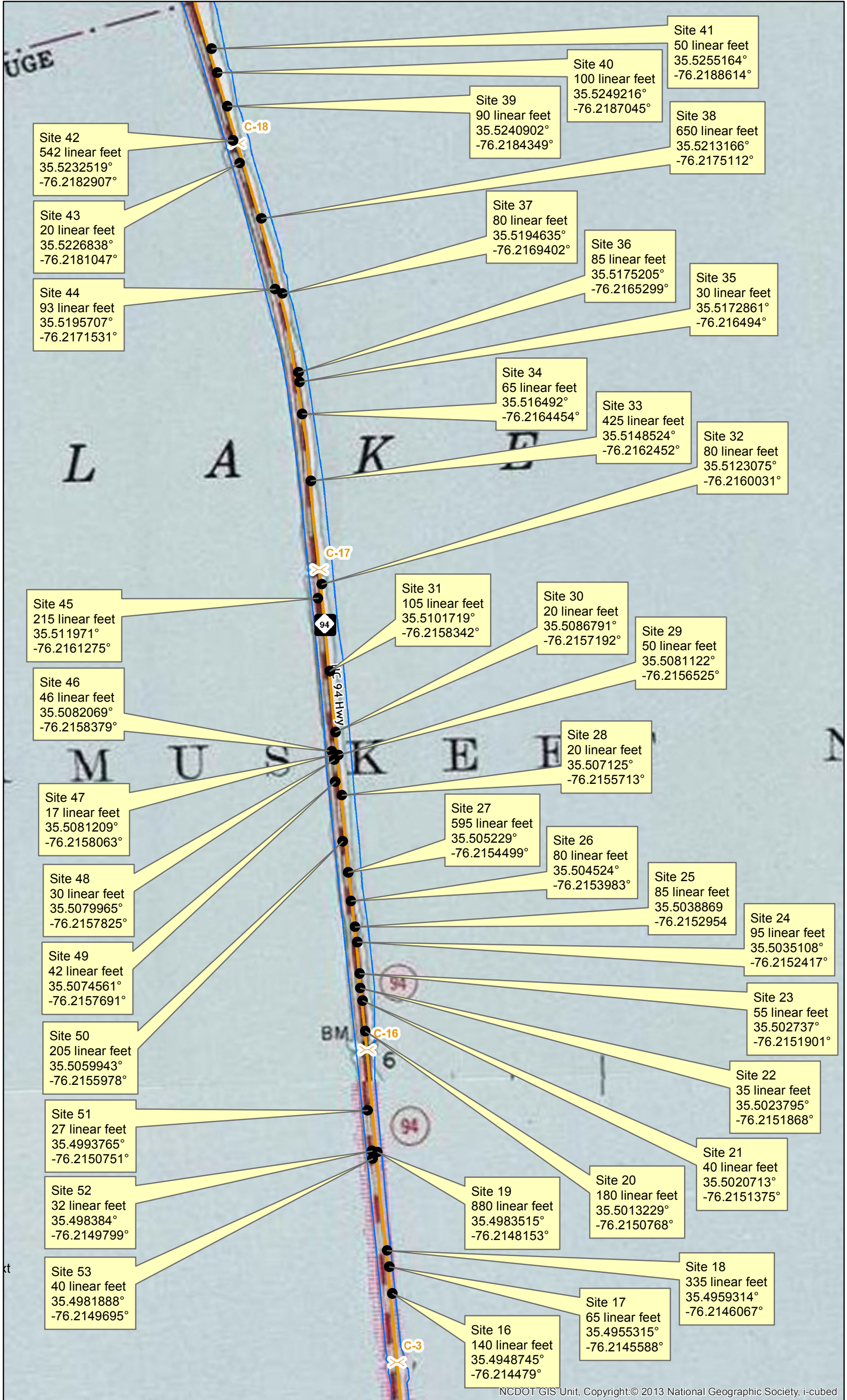

NCDOT GIS Unit, Copyright:© 2013 National Geographic Society, i-cubed

# DETAIL SECTION - CROSS SECTION 'A'

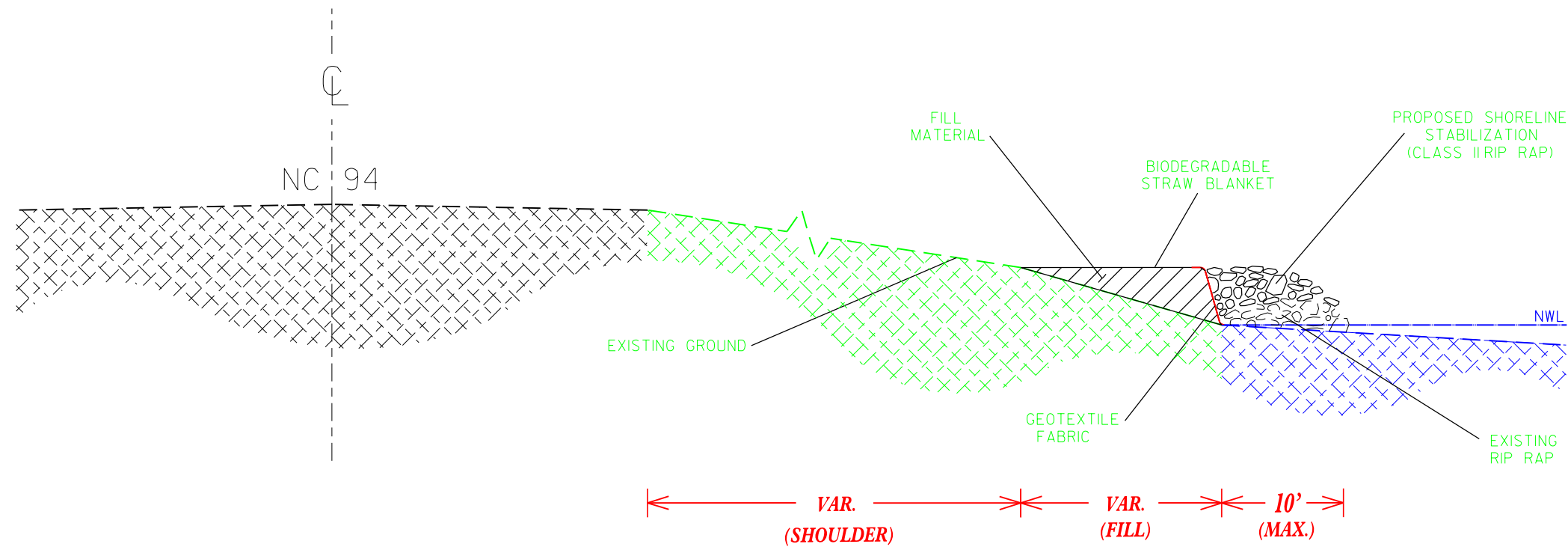

NOTE: PROPOSED CLASS II RIP RAP IS TO BE PLACED ON EXISTING RIP RAP

NOTE: PROPOSED CLASS II RIP RAP IS TO BE PLACED ON AN APPROVED GEOTEXTILE FABRIC

LEGEND	
---	EXISTING
—	PROPOSED

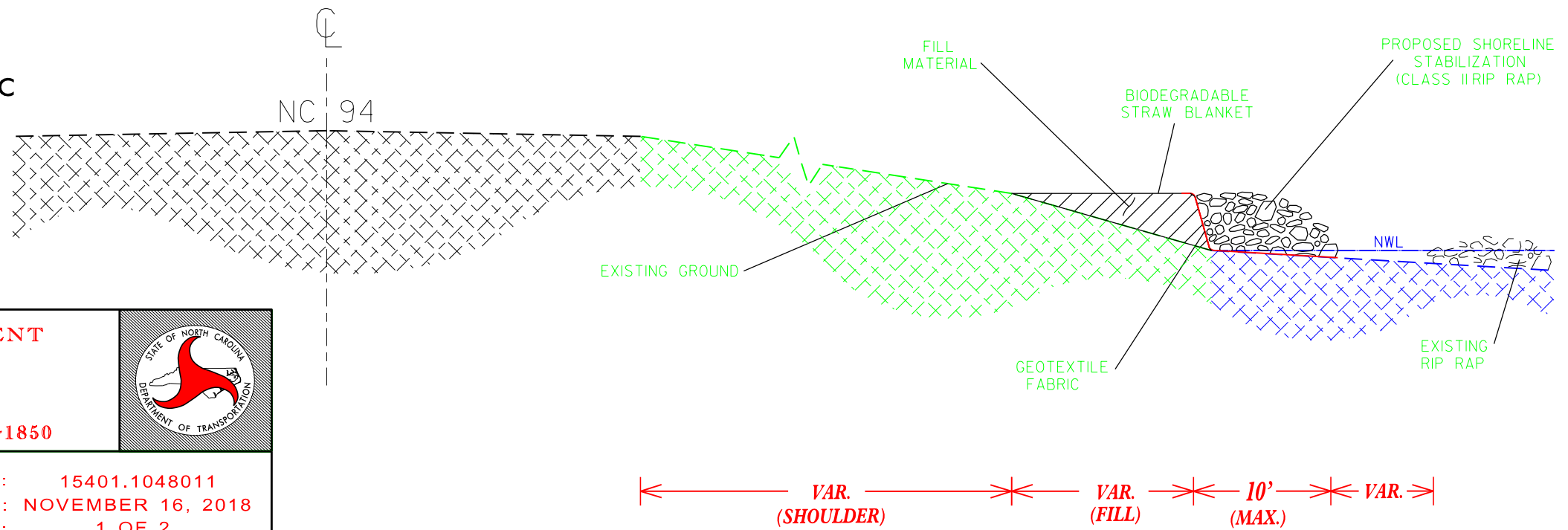

# DETAIL SECTION - CROSS SECTION 'B'

**NORTH CAROLINA DEPARTMENT  
OF TRANSPORTATION  
DIVISION 1  
113 AIRPORT DR.  
EDENTON, NC 27932 (252) 482-1850**

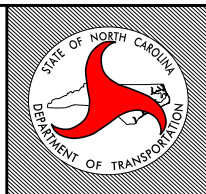

COUNTY: HYDE                      WBS#: 15401.1048011  
 QUAD: FAIRFIELD/NEW HOLLAND      DATE: NOVEMBER 16, 2018  
 BASIN: PASQUOTANK              SHEET #: 1 OF 2

SHORELINE STABILIZATION ON LAKE MATTAMUSKEET CAUSEWAY

LAT. = 35.4673548              LONG. = -76.2122380

DRAWN BY: D.H. STALLINGS              SCALE: 1 : 5

# DETAIL SECTION – CROSS SECTION 'C'

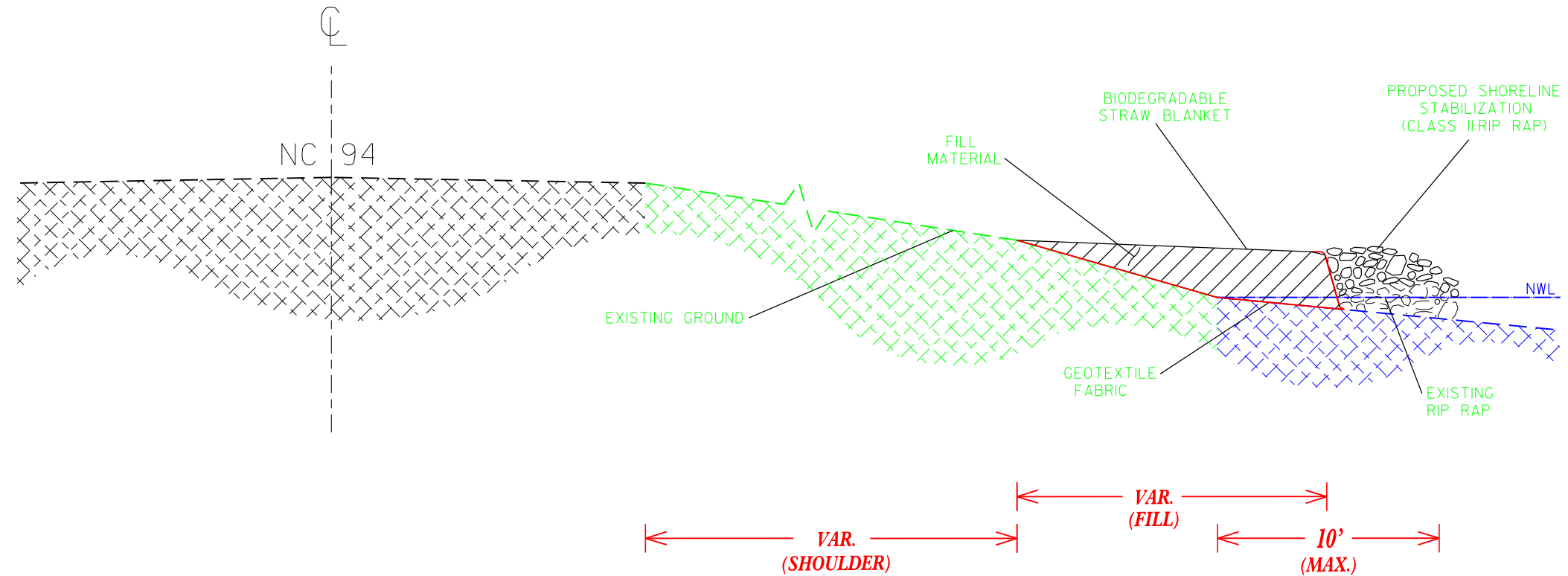

NOTE: PROPOSED CLASS II RIP RAP IS TO BE PLACED ON EXISTING RIP RAP

# DETAIL SECTION – CROSS SECTION 'D'

LEGEND	
---	EXISTING
—	PROPOSED

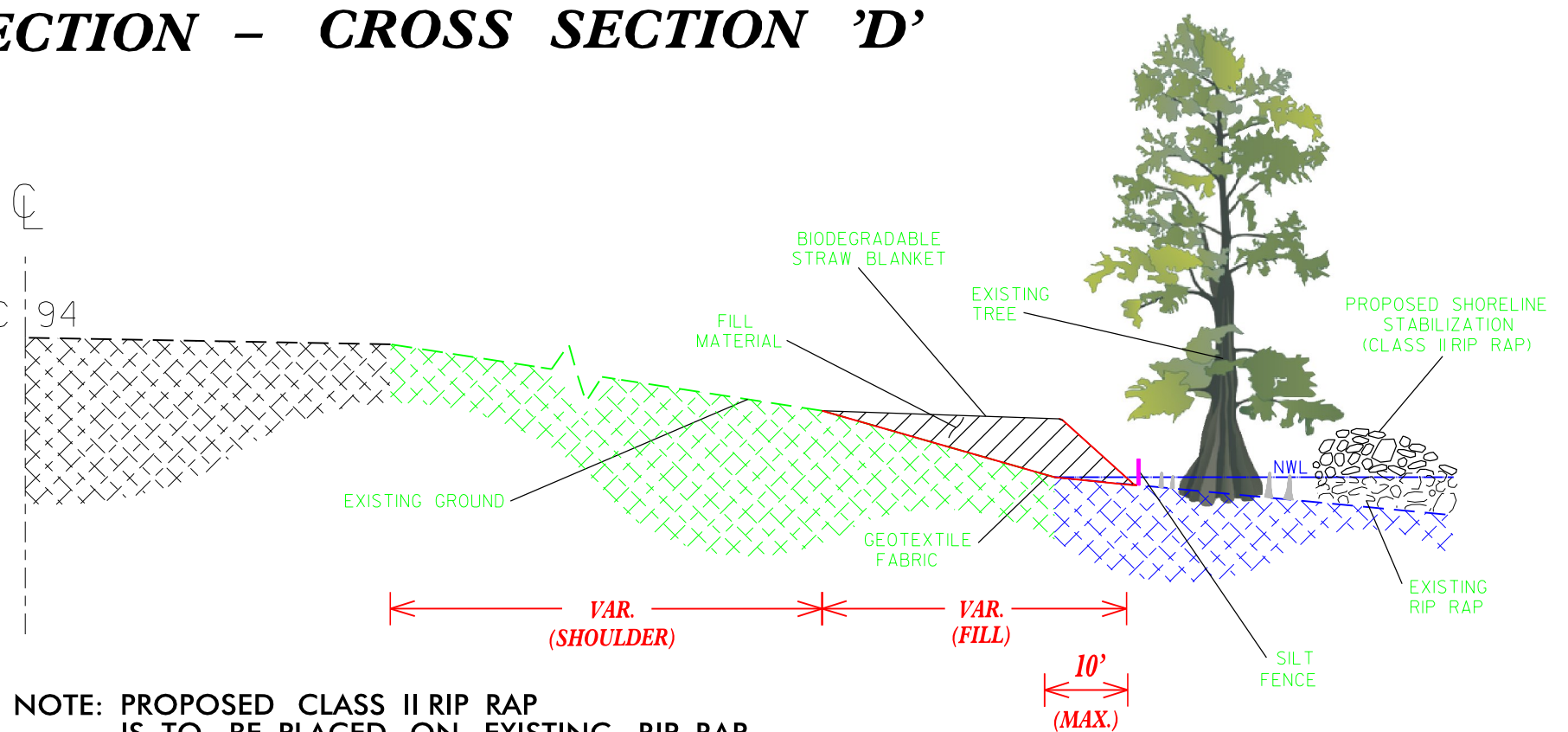

NOTE: PROPOSED CLASS II RIP RAP IS TO BE PLACED ON EXISTING RIP RAP

**NORTH CAROLINA DEPARTMENT OF TRANSPORTATION**  
 DIVISION 1  
 113 AIRPORT DR.  
 EDENTON, NC 27932 (252) 482-1850

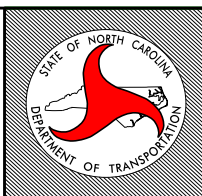

COUNTY: HYDE WBS#: 15401.1048011  
 QUAD: FAIRFIELD/NEW HOLLAND DATE: NOVEMBER 16, 2018  
 BASIN: PASQUOTANK SHEET #: 2 OF 2

SHORELINE STABILIZATION ON LAKE MATTAMUSKEET CAUSEWAY

LAT. = 35.4673548 LONG. = -76.2122380

DRAWN BY: D.H. STALLINGS SCALE: 1 : 5



### NC 94 Mattamuskeet Causeway Shoreline Stabilization

Location	Latitude	Longitude	Total Length (FT)	Repaired Riprap Length (FT)	Surface Water Impact (Sq. Ft.)	Typical Cross Section(s)	Borrow (Sq ft / ft)	Borrow Qty (Cubic Yards)	Rip Rap (Sq ft / ft)	Rip Rap Qty (Tons)
1	35.4673548	-76.212238	370	360	100	A, C	12.17	166.77	6.01	166.78
2	35.4687578	-76.2122702	50	0	300	B	24.88	46.07	17.52	65.70
3	35.4703197	-76.2123818	115	115	0	A	2.85	12.14	2.35	20.27
4	35.4717647	-76.2125387	100	100	0	A	13.16	48.74	1.97	14.78
5	35.4723856	-76.212588	200	200	0	A	13.92	103.11	6.02	90.30
6	35.473604	-76.2127158	75	75	0	A	10.74	29.83	11.09	62.38
7	35.4743758	-76.2127879	220	220	0	A	5.86	47.75	2.44	40.26
8	35.4756736	-76.2128844	95	65	240	A, C	15.02	52.85	5.11	36.41
9	35.4770109	-76.2130018	170	170	0	A	20.24	127.44	8.76	111.69
10	35.4776708	-76.2130514	110	30	800	A, C	17.57	71.58	15.32	126.39
11	35.4783542	-76.2131077	75	75	0	A	14.6	40.56	9.06	50.96
12	35.4790564	-76.2131634	190	190	0	A	8.198	57.69	4.32	61.56
13	35.4799754	-76.2132592	320	285	350	A, C, D	22.81	270.34	8.52	204.48
14	35.4812057	-76.2133508	290	230	600	A, C, D	19.11	205.26	6.99	152.03
15	35.4823196	-76.2134467	35	0	200	C	10.14	13.14	8.08	21.21
16	35.4948745	-76.214479	140	0	0	B, D	18.82	97.59	6.85	71.93
17	35.4955315	-76.2145588	65	0	0	B	21.04	50.65	13.64	66.50
18	35.4959314	-76.2146067	335	0	0	B	40.69	504.86	21.53	540.94
19	35.4983515	-76.2148153	880	0	0	B	31.73	1034.16	14.6	963.60
20	35.5013229	-76.2150768	180	0	0	B	18.82	125.47	11.72	158.22
21	35.5020713	-76.2151375	40	0	320	B	17.52	25.96	15.29	45.87
22	35.5023795	-76.2151868	35	0	0	B	6.32	8.19	5.85	15.36
23	35.502737	-76.2151901	55	0	0	B	10.09	20.55	9.11	37.58
24	35.5035108	-76.2152417	95	95	0	A	6.35	22.34	9.55	68.04
25	35.5038869	-76.2152954	85	0	150	B	13.22	41.62	9.5	60.56
26	35.504524	-76.2153983	80	0	20	C	14.65	43.41	7.13	42.78
27	35.505229	-76.2154499	595	565	300	A,C,D	8.47	186.65	8.25	368.16
28	35.507125	-76.2155713	20	20	0	A	5.14	3.81	5.62	8.43
29	35.5081122	-76.2156525	50	50	0	A	8.72	16.15	8.82	33.08
30	35.5086791	-76.2157192	20	0	0	B	15.1	11.19	14.02	21.03
31	35.5101719	-76.2158342	105	65	240	A,C,D	8.51	33.09	9.67	76.15
32	35.5123075	-76.2160031	80	80	0	A	2.41	7.14	6.7	40.20
33	35.5148524	-76.2162452	425	425	0	A	19.57	308.05	12.27	391.11

**NC 94 Mattamuskeet Causeway Shoreline Stabilization (Continued)**

Location	Latitude	Longitude	Total Length (FT)	Repaired Riprap Length (FT)	Surface Water Impact (Sq. Ft.)	Typical Cross Section(s)	Borrow (Sq ft / ft)	Borrow Qty (Cubic Yards)	Rip Rap (Sq ft / ft)	Rip Rap Qty (Tons)
34	35.516492	-76.2164454	65	65	0	D	9.2	22.15	6	29.25
35	35.5172861	-76.216494	30	30	0	A	2.22	2.47	2.86	6.44
36	35.5175205	-76.2165299	85	85	0	A	8.93	28.11	8	51.00
37	35.5194635	-76.2169402	80	80	0	A	2.69	7.97	3.51	21.06
38	35.5213166	-76.2175112	650	650	0	A	4.46	107.37	6.35	309.56
39	35.5240902	-76.2184349	90	90	0	A	3.3	11.00	5.38	36.32
40	35.5249216	-76.2187045	100	100	0	A	14.28	52.89	11.1	83.25
41	35.5255164	-76.2188614	50	0	0	B	5.83	10.80	5.26	19.73
42	35.5232519	-76.2182907	542	517	250	A, C	11.65	233.86	6.26	254.47
43	35.5226838	-76.2181047	20	0	200	B	2.58	1.91	11.1	16.65
44	35.5195707	-76.2171531	93	0	744	C	20.64	71.09	13.13	91.58
45	35.511971	-76.2161275	215	0	1720	B	19.95	158.86	11.57	186.57
46	35.5082069	-76.2158379	46	0	368	B	9.32	15.88	14.98	51.68
47	35.5081209	-76.2158063	17	0	170	B	9.84	6.20	15.46	19.71
48	35.5079965	-76.2157825	30	0	120	B	12.23	13.59	14.07	31.66
49	35.5074561	-76.2157691	42	0	252	B	8.19	12.74	9.12	28.73
50	35.5059943	-76.2155978	205	60	725	B	14.01	106.37	14.02	215.56
51	35.4993765	-76.2150751	27	0	270	B	4.03	4.03	10.5	21.26
52	35.498384	-76.2149799	32	0	320	B	7.8	9.24	13.43	32.23
53	35.4981888	-76.2149695	40	0	400	B	17.33	25.67	13.02	39.06
54	35.4790704	-76.2133659	35	0	280	B	5.3	6.87	10.85	28.48
55	35.477125	-76.2131962	21	0	210	C	8.85	6.88	9.37	14.76
		<b>Total:</b>	<b>8,215</b>	<b>5,092</b>	<b>9,649</b>					
							Subtotal:	4750.10		5823.71
							+25%	5937.63		
							<b>Say:</b>	<b>5,950 C.Y.</b>		<b>5,900 Tons</b>

PROJECT NO.	SHEET NO.	TOTAL NO.
15401.1048011		

## SUMMARY OF QUANTITIES

PROJECT NO	COUNTY	MAP NO	ROUTE	DESCRIPTION	TYP NO	LANES	LANE TYPE	FINAL SURFACE TESTING REQUIRED	WARM MIX ASPHALT REQUIRED	LENGTH	WIDTH	MOBILIZATION	BORROW EXCAVATION	GEOTEXTILE FOR SOIL STABILIZATION	SHOULDER & SLOPE RECONSTRUCTION	RIP RAP, CLASS II	GENERIC TRAFFIC CONTROL ITEM	TEMPORARY SILT FENCE	SEED & MULCHING	NATURAL FIBER MATTING	WORK ZONE ADVANCE/GENERAL WARNING SIGNING
										MI	FT	LS	CY	SY	SY	TON	LS	LF	AC	SY	SF
15401.1048011	Hyde	1	NC94	1.8 MILES NORTH OF US 264 TO 3.8 MILES TOWARDS FAIRFIELD	A-D	2	2WU	NO	NO	1.56	15	1	5,950	18,300	9,150	5,900	1	500	1.89	9,130	64
<b>GRAND TOTAL</b>										<b>1.56</b>		<b>1</b>	<b>5,950</b>	<b>18,300</b>	<b>9,150</b>	<b>5,900</b>	<b>1</b>	<b>500</b>	<b>1.89</b>	<b>9,130</b>	<b>64</b>